

# TECHNICAL DATASHEET

## SPIDER-2D GU10 NICKEL IP44

02-07-2020

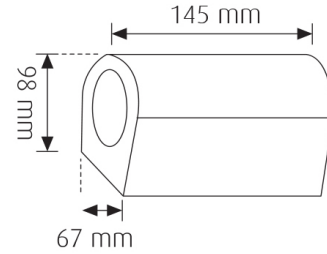

VT/SPIDER-2D/GU10/NCK/IP44/220V/OUTWALL

NOTES

### General Informations

Stock Code	3230060
HSC/GTIP Code	9405.10.91.50.00
EAN-13 (Inbox Barcode)	8699187547679
ITF-14 (Outbox Barcode)	38699187547670

### Mechanical Parameters

IP Protection Class	IP44
Body Material	Glass & Aluminum
Body Colour	Nickel
Diffuser Material	Glass
Ambient Temperature (Ta)	-20°C<Ta<50°C

### Electrical Characteristics

Current Type	AC
Operation Voltage	220-240 Volt
Operation Frequency	50/60 Hertz
Power	Max 35 Watt
Electrical Protection Class	Class I

### Logistic Informations

Outbox Length	320 millimeter
Outbox Width	320 millimeter
Outbox Height	220 millimeter
Outbox Volume	0,022528 m <sup>3</sup>
Outbox Quantity	16 pieces
Unit Net Weight	0,5125 kilogram
Outbox Net Weight	8,2 kilogram
Outbox Gross Weight	9,5 kilogram

### Lighting Characteristics

Light Beam Angle	360°
------------------	------

IMPORTANT NOTES: VITO reserves the right to change/remove models or specifications partially/completely without any notice. Information, models and photographs of the products in this technical datasheet can not be used, reproduced or published without permission. However, some parts can be quoted by giving reference and/or chapter number belonging to technical datasheet. Most of the items in the datasheet have been designed by our company within indicated technical specifications inside. Our company is not responsible for errors caused by wrong installation and operating against rules according to qualifications specified in the product details. Photographs printed in this datasheet may not reflect the actual color of the product depending on printing conditions. In the same context, typographical errors may possibly be found in the texts.